

■ **LEP Single-line Lubrication Pump Unit**



◇ **Product Description**

LUBE lite™ single-line pump unit is a kind of low-cost but high-quality pump unit which is being used in construction machinery, on-road machine, machine tool and general machinery widely.

This pump unit has a preset operating pressure of 250 bar (adjustable between 210 bar and 345 bar in terms of piping back-pressure condition). Hence, the applicable lubricant viscosity can be as high as NLGI 2 grease.

Each lubrication pump can have only 1 pump element installed with displacement of 6.0 cm³/min, forming 1 single-line lubrication system.

◇ **Product Features**

1. Strong and stable power: BLDC motor or AC motor.
2. Pressure adjustable relief valve: suitable for different system back pressures.
3. Higher protection class: IP 66.
4. High-performance plastics plus die-cast aluminum alloy pump body: reduces overall weight but increases the pump strength.
5. The wider temperature tolerance range improves the pump's operating capability.

◇ **Technical Data**

<i>Power Supply</i>	DC 24 V or AC 230V/50 Hz	<i>Tank Capacity</i>	8, 10 L
<i>Rated Power</i>	< 100 W	<i>Refilling Port</i>	DIN 71412 A and/or top lid
<i>Power Socket</i>	DIN 43650 A	<i>IP Class</i>	IP 66
<i>Pump Delivery</i>	6.0 cm ³ /min	<i>Lubricant</i>	NLGI 0, 1, 2
<i>Outlet Thread</i>	1 x G 1/4	<i>Mounting</i>	Vertical
<i>Working Pressure</i>	210 ~ 345 bar adjustable, preset 250 bar	<i>Working Temperature</i>	-41 °C ~ +70 °C

■ **LEP Single-line Lubrication Pump Part Number**

LEP21 3 M GL CH A0 D24

LUBElite 21 series pump station

Tank capacity

3: 8L

10: 10L

Pump type

M: Single-line pump unit

MT: Single-line pump unit with top lid

Low level alarm

GL: DC 24V, PNP NC

GN: No

Controller type

CH: Controller integrated, unit of interval time is Hour

CM: Controller integrated, unit of interval time is Minute

Signal and cable code

Refer to below table

Power supply

D24: DC 24V, power socket (DIN 43650A)

D24V: DC 24V, power socket (DIN 43650A), with 5m cable

A23: AC 230V / 50Hz, power socket (DIN 43650A)

A23V: AC 230V / 50Hz, power socket (DIN 43650A), with 5m cable

Signal and cable code explanation

The external signal cable kit has two options and they are mutually exclusive. All external signal cables are 5m length.

Controller		Low level sensor			External signal interaction				External signal cable kit	
		No	Yes		Remote alarm (NO)	Pulse	Remote startup	Modbus	No kit code	Kit code
Integrated	Signal Code		Signal to controller	Signal to customer						
No (C0)	0	X							0	
				X					1	
Yes (CH/CM)	A	X							0	
			X						0	
	B	X			X				0	B
	D	X					X		0	D
	E	X						X	0	E
	F	X			X				0	F
			X		X					
	H	X					X		0	H
			X				X			
	J	X						X	0	J
		X					X			
L	X			X		X		0	L	
M	X			X			X	0	M	

■ LEP Lubrication Pump Unit Dimension

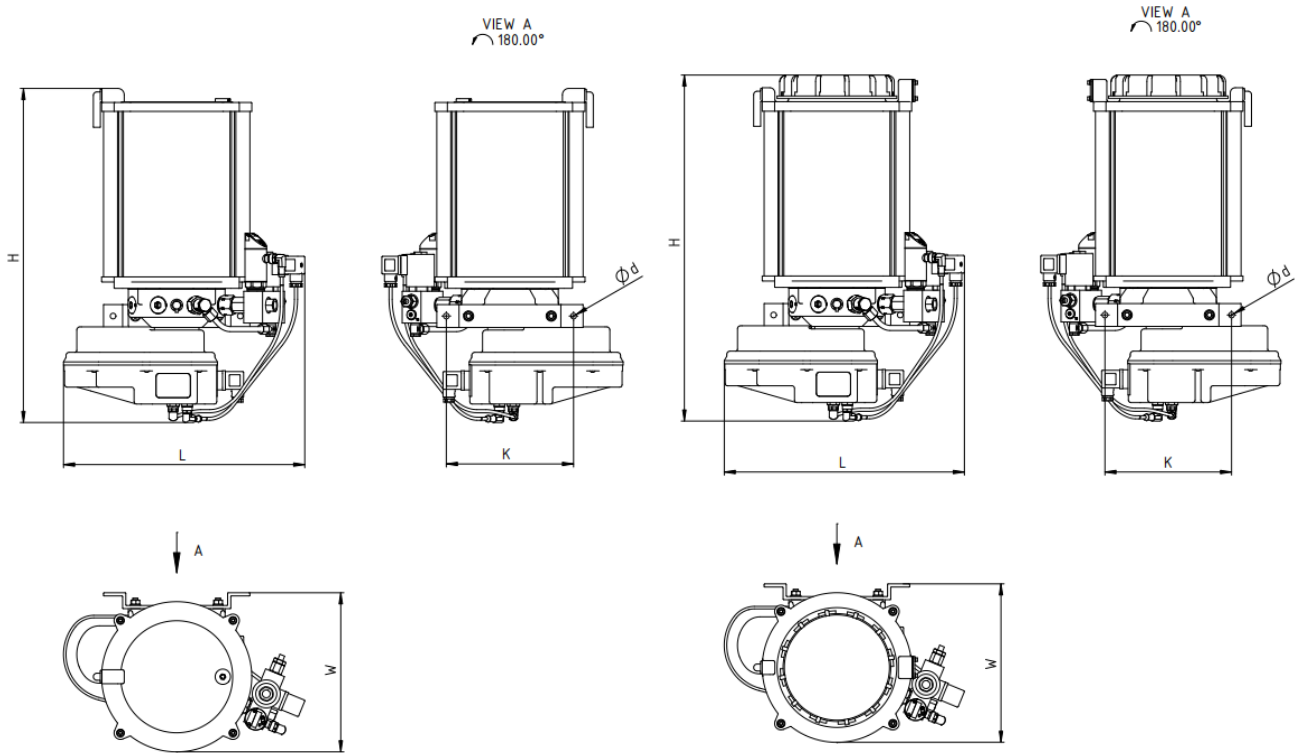

Model	Pump Outlet	Power Supply	Tank Capacity (L)	H (mm)	W (mm)	L (mm)	K (mm)	Ød (mm)
LEP213M...	G 1/4	DC 24V or AC 230V/50Hz	8	525	250	380	200	9
LEP213MT...				545				
LEP2110M...			10	555	250	380	200	9
LEP2110MT...				575				

■ **SFM-1 Single-line Grease Injector**



✧ **Product Description**

The SFM-1 series grease injectors are used in single-line, high-pressure centralized lubrication systems. It can accommodate lubricants with viscosity of up to NLGI 2.

The grease injector can be easily disassembled for inspection or replacement. The injector is solid and reliable, and can be widely used in wind energy, automatic machinery and general machinery, etc.

✧ **Product Features**

1. The number of outlets for a single-line injector can be chosen from 1 to 6.
2. Adjust the grease flow of each outlet by rotating the adjustment screw.
3. Integrated visual indicator to monitor the working status of each point.
4. The single injector is easy to disassemble and replace.

✧ **Technical Data**

<i>Working Principle</i>	Intermittent
<i>Number of Outlet</i>	1 ~ 6
<i>Displacement of Each Cycle</i>	0.02 ~ 0.13 cm ³ /cycle, adjustable
<i>Working Pressure</i>	Max. 240 bar
<i>Open pressure</i>	80 bar
<i>Relief Pressure</i>	15 bar
<i>Lubricant</i>	NLGI 0, 1, 2
<i>Working Temperature</i>	-26 °C ~ +80 °C
<i>Inlet / Outlet Thread</i>	Inlet: 1/4 NPT, Outlet: M10x1
<i>Mounting</i>	Any position

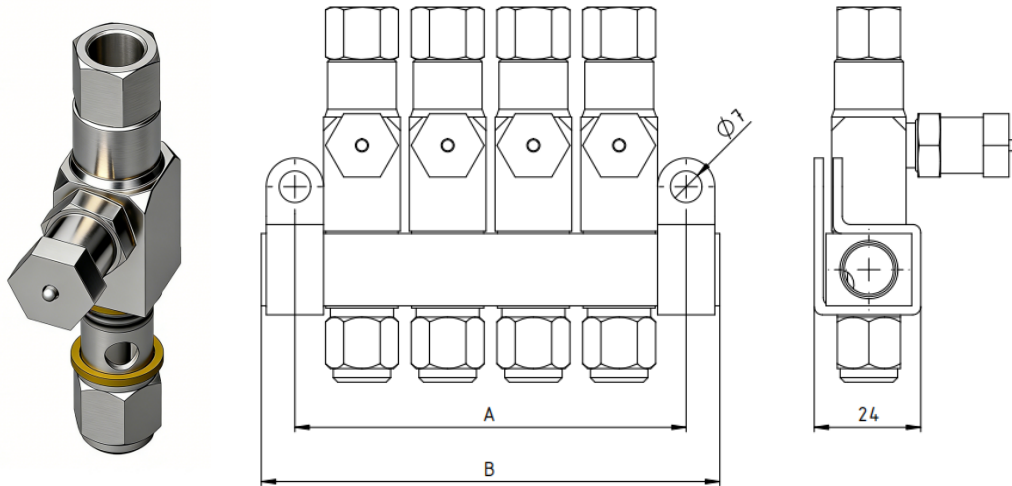

Model	Name	Number of Outlet	Displacement of Single Injector in Each Cycle	Dimension (mm)	
				A	B
SFM-1-1	Single-line injector (w. bar)	1	0.02 cm ³ ~ 0.13 cm ³	30	44.6
SFM-1-2	Single-line injector (w. bar)	2	0.02 cm ³ ~ 0.13 cm ³	48	63.6
SFM-1-3	Single-line injector (w. bar)	3	0.02 cm ³ ~ 0.13 cm ³	68	82.6
SFM-1-4	Single-line injector (w. bar)	4	0.02 cm ³ ~ 0.13 cm ³	87	101.6
SFM-1-5	Single-line injector (w. bar)	5	0.02 cm ³ ~ 0.13 cm ³	106	120.6
SFM-1-6	Single-line injector (w. bar)	6	0.02 cm ³ ~ 0.13 cm ³	125	139.6
SFM-1	Injector (w/o bar)	1	0.02 cm ³ ~ 0.13 cm ³	/	/

Statement:

Without permission, all or part of the contents in this manual shall not be quoted or copied. We have tried our best to ensure that the contents in this manual are accurate. Our company does not assume any direct, indirect or joint liability for the use of any technology and related products mentioned in this manual without our approval.

Publication No.: INALUBE-LUBEite/Singleline-01

Version: 1.0

Date: 2026.03

Shanghai INA Machinery Science & Technology Co., Ltd

Room 201, Building D, No.555 Wanfang Road, Minhang District, Shanghai, China

Tel.: +86 21 2042 2806

Mobile: +86 187 1781 3303

Email: sales@inalube.com

Website: www.inalube.com